



More Information:

Contact Isa Mashni
imashni@colemangroup.net
(859) 255-8855 - Office
(859) 421-6700 - Cell
colemangroup.net

249 EAST MAIN STREET LEXINGTON, KY 40507

PROPERTY FEATURES:

- ☑ Highly Visible Building
- ☑ Property Type: Professional Office
- ☑ Building Class: Class A
- ☑ Building Size: 46,936 SF
- ☑ Space Sizes Available: 2,100 SF – 7,526 SF
- ☑ Rental Rate: \$20.00 PSF Full Service
- ☑ Parking: 100+ street level spaces
- ☑ Modern Interior Architectural Design
- ☑ Great Downtown Lexington Location
- ☑ Join Tenant CMW Architects, Cornett Advertising Group

ARE YOU READY TO ELEVATE YOUR BUSINESS?

249 E. Main is located in the Central Business District Between Rose Street and Martin Luther King Blvd. The open atrium, glass elevator shaft, exposed brick and modern finishes make this property exceptional.

WHY CHOOSE THIS SPACE?

- ☑ Class A Office Space in Historic Building
- ☑ 100+ street level parking spaces
- ☑ Great downtown location
- ☑ Modern finishes
- ☑ Professional Business Lobby
- ☑ Spaces Available: (See website.)

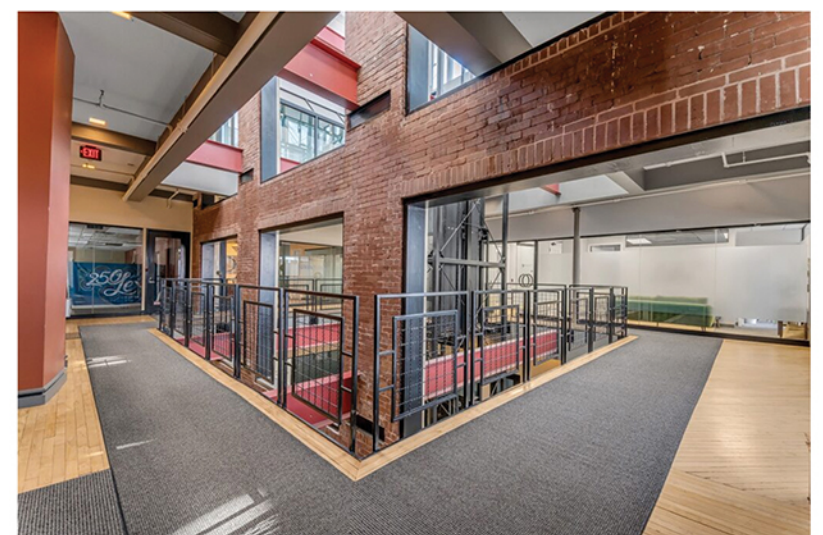

⇒ <https://colemangroup.net/property/249-e-main-street-lexington-ky/>



COLEMAN GROUP

COMMERCIAL REAL ESTATE & PROPERTY MANAGEMENT



COLEMAN GROUP
COMMERCIAL REAL ESTATE & PROPERTY MANAGEMENT

249 MAIN | 249 EAST MAIN LEXINGTON, KENTUCKY 40507

FLOOR PLANS:

THIRD FLOOR PLAN

JULY 2025 - NOT TO SCALE
NOT FOR PLANNING OR CONSTRUCTION - FIELD VERIFY

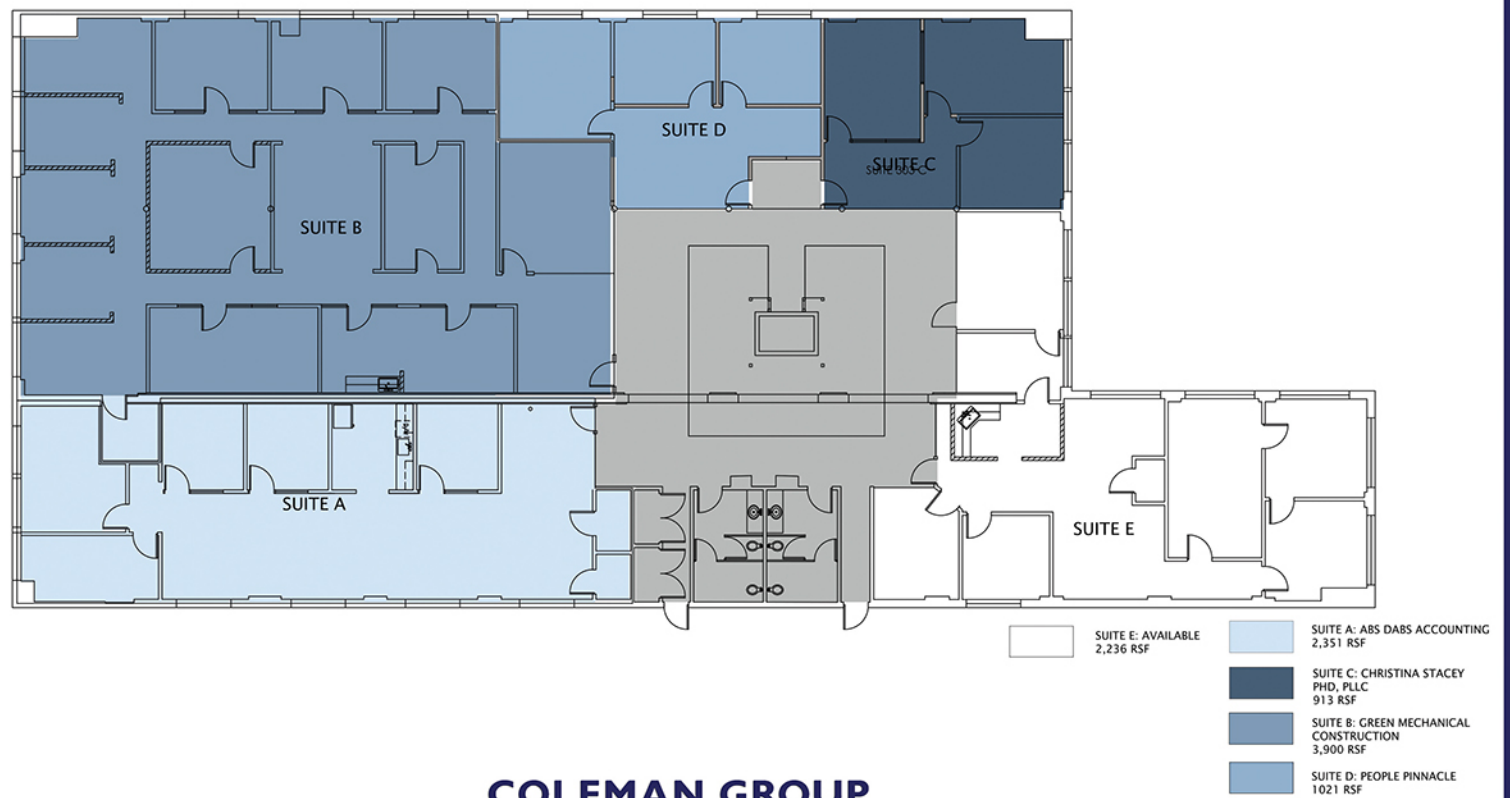

COLEMAN GROUP
COMMERCIAL REAL ESTATE & PROPERTY MANAGEMENT

249 MAIN | 249 EAST MAIN LEXINGTON, KENTUCKY 40507

SECOND FLOOR PLAN

SEPTEMBER 2021 - NOT TO SCALE
NOT FOR PLANNING OR CONSTRUCTION - FIELD VERIFY

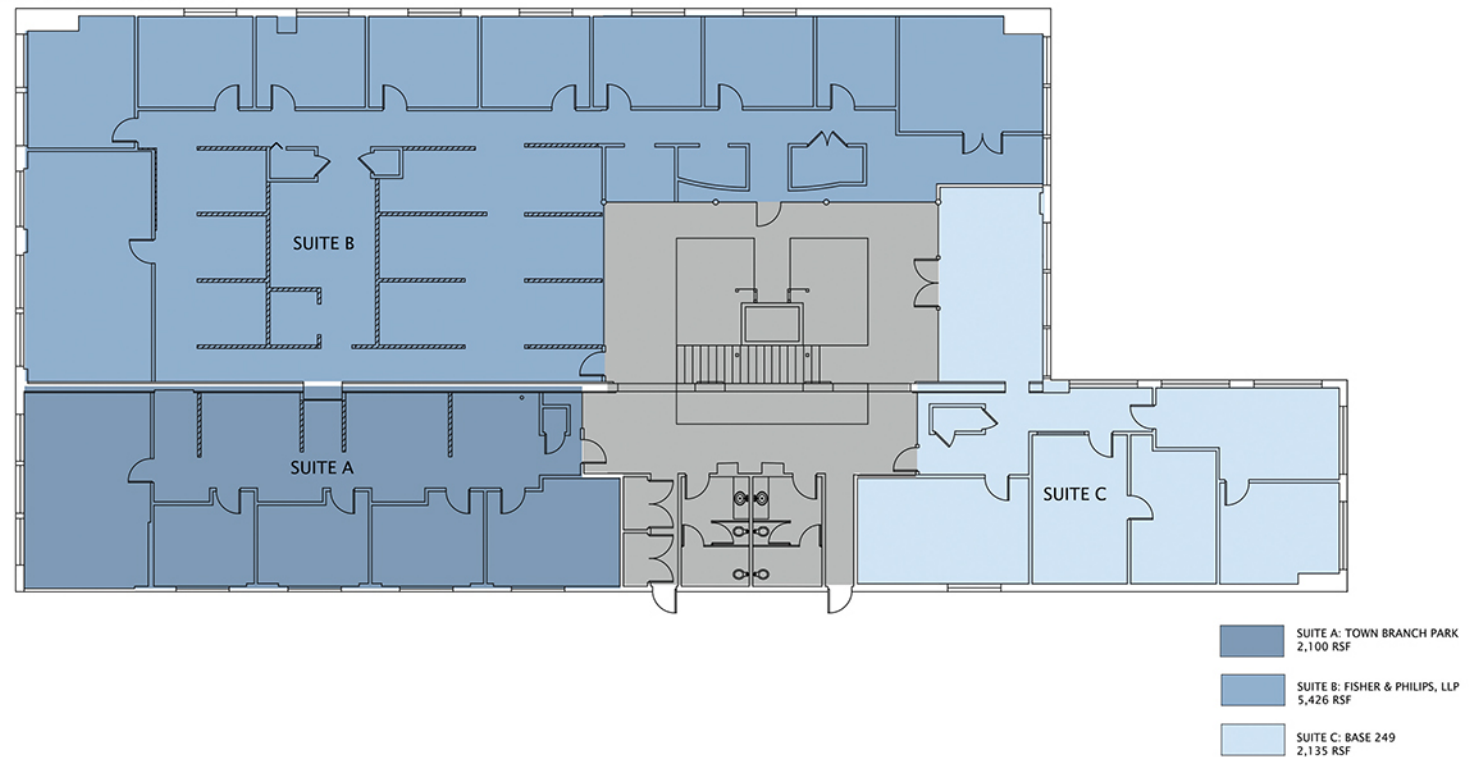

COLEMAN GROUP
COMMERCIAL REAL ESTATE & PROPERTY MANAGEMENT